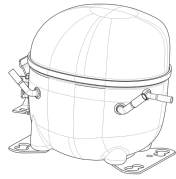

**220-240V 50 1~****GENERAL DATA**

**Application:** LBP  
**Refrigerant:** R134a  
**Evaporating Temperature Range:** -30°C to -5°C  
**Compressor Cooling:** Static  
**Type:** Hermetic reciprocating  
**Technology Type:** On-Off  
**Expansion Device:** Capillary Tube  
**Packing Quantity:** Single - 1 pc  
**Displacement:** 8.39 cm<sup>3</sup>  
**Horse power:** 1.4 hp

Approvals:   

**MECHANICAL DATA**

**Bore:** 24.28 mm  
**Stroke:** 18.12 mm  
**Oil Charge:** 350ml +/-15ml  
**Free Internal Volume:** 2.1 cm<sup>3</sup>  
**Maximum Recommended Refrigerant Charge:** 350 g  
**Oil Type Configuration:** Polyolester  
**Oil Type Viscosity:** ISO22  
**Compressor pressurization:** Dry air charge  
**Weight:** 10.7 kg

**ELECTRICAL DATA**

**Motor Type:** RSIR  
**Starting Torque:** LST  
**Voltage working range at 50 Hz:** 198-254 V  
**Maximum Motor Temperature:** 130 °C  
**Start Winding Resistance:** 14.1 Ω (± 10%) at 25°C  
**Run Winding Resistance:** 13 Ω (± 10%) at 25°C  
**Locked Rotor Amperage (LRA):** 7 A

**MOUNTING ACCESSORIES**

	Description	Code
<b>Terminal Board:</b>	no	-
<b>Overload Protector Bracket:</b>	no	-
<b>Capacitor Bracket:</b>	no	-
<b>Washer:</b>	no	-
<b>Pin:</b>	no	-
<b>Clip:</b>	no	-
<b>Rotolock valve:</b>	no	-
<b>Cover:</b>	yes	2075282
<b>Anchorage:</b>	yes	1027058
<b>Grommets:</b>	yes	2221011
<b>Sleeves:</b>	yes	2222018

**ELECTRICAL COMPONENTS**

	Component type	Description	Code
<b>Starting Device:</b>	PTC	PTC 230V	1260011
<b>Motor Protection:</b>	External 3/4"	T0503/07   MRP357JZ-3166	2288072   2288306

**EXTERNAL CHARACTERISTICS**

**Base Plate:** European  
**Tray Holder:** Yes  
**Height:** 200 mm

	Internal Diameter (mm)	Material	Shape
<b>Suction Connector</b>	6.1	Copper	Slanted 42°
<b>Discharge Connector</b>	4.86	Copper	Straight
<b>Process Connector</b>	6.1	Copper	Slanted 42°

**RATED POINT DATA**

Cooling Capacity (W)	Power Consumption (W)	Current Consumption (A)	Gas Flow Rate (kg/h)	Efficiency (W/W)
±5%	±5%	±5%	±5%	±7%
228	160	0.96	4.41	1.42

Test condition: ASHRAE, Static, Return Gas 32.2°C, Evaporating: -23.3°C, Condensing: 54°C, Ambient: 32.2°C, Liquid: 32.2°C

**PERFORMANCE CURVE DATA****220V 50Hz**

Condensing Temperature (°C)	Evaporating Temperature (°C)	Cooling Capacity (W)	Power Consumption (W)	Current Consumption (A)	Gas Flow Rate (kg/h)	Efficiency (W/W)
		±5%	±5%	±5%	±5%	±7%
<b>35°C</b>	-5	592	247	1.48	11.62	2.40
	-10	482	215	1.26	9.43	2.25
	-15	386	186	1.09	7.53	2.07
	-20	305	162	0.96	5.92	1.89
	-25	237	141	0.88	4.60	1.69
	-30	184	124	0.83	3.56	1.49

Condensing Temperature (°C)	Evaporating Temperature (°C)	Cooling Capacity (W)	Power Consumption (W)	Current Consumption (A)	Gas Flow Rate (kg/h)	Efficiency (W/W)
		±5%	±5%	±5%	±5%	±7%
<b>45°C</b>	-5	567	262	1.49	11.12	2.16
	-10	461	229	1.29	9.00	2.02
	-15	368	198	1.13	7.16	1.86
	-20	288	171	1.00	5.59	1.69
	-25	221	146	0.90	4.28	1.51
	-30	167	124	0.83	3.24	1.35

Condensing Temperature (°C)	Evaporating Temperature (°C)	Cooling Capacity (W)	Power Consumption (W)	Current Consumption (A)	Gas Flow Rate (kg/h)	Efficiency (W/W)
		±5%	±5%	±5%	±5%	±7%
<b>55°C</b>	-5	541	277	1.50	10.62	1.95
	-10	439	242	1.32	8.58	1.81
	-15	349	210	1.17	6.80	1.66
	-20	271	179	1.04	5.26	1.51
	-25	205	151	0.92	3.97	1.36

Test condition: ASHRAE, Static, Return Gas 32.2°C, Ambient: 32.2°C, Liquid: 32.2°C

**ASSEMBLY INSTRUCTION**

**WIRING DIAGRAM**

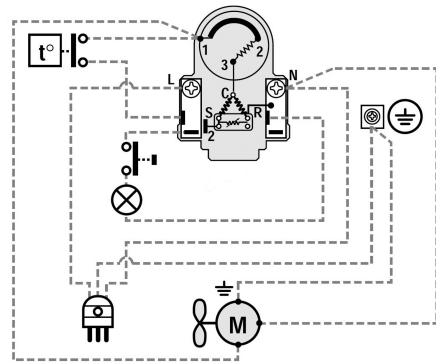
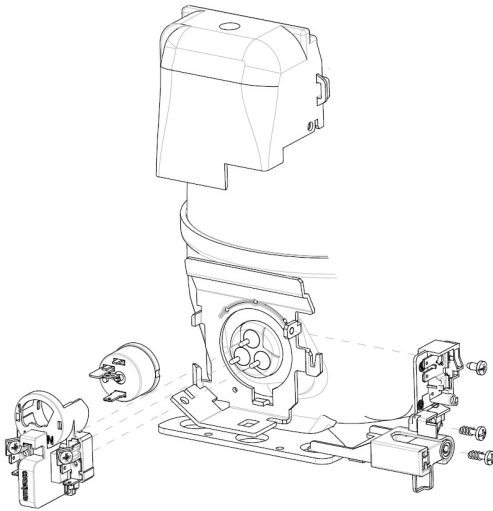

**OPERATING ENVELOPE**

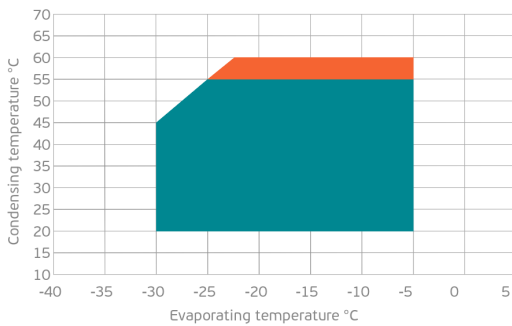

- Operating Condition
- Transient Condition
- Superheating

**NOTE:** usage of compressors outside of intended working range cannot make use of the warranty, or should be consulted with Technical support.

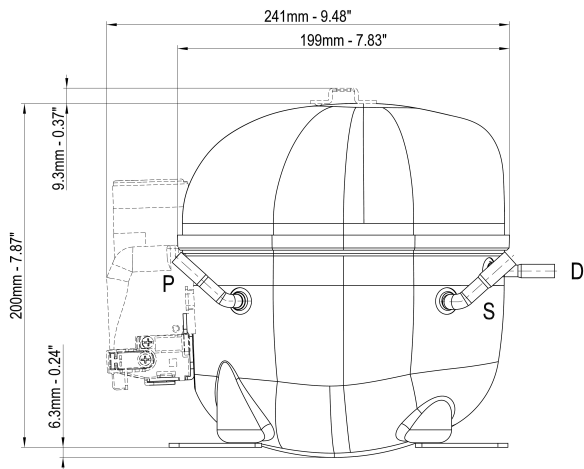

	∅ mm	∅ in	Material
<b>S - Suction</b>	6.10-6.20	0.24	Cu
<b>P - Process</b>	6.10-6.20	0.24	Cu
<b>D - Discharge</b>	4.86-5.03	0.19	Cu

